

ADDENDUM 1

2017-020

INFRASTRUCTURE AND WIFI

April 2017

2017-020 Infrastructure and WIFI

Questions/Clarifications

1. Of the 85 AP's that are being quoted, how many will replace existing AP hardware vs how many will require brand new drops?

53 existing and approximately 25 of category six new drop.

2. Cabling Standards?

T568B giga punch Panduit, category 6 tested and certified.

3. Is cabling required for any/all of these access points?

As stated in question 1, approximately 25.

4. If there is existing cabling for these access points, what category of cabling is in place?

Same answer as question 2.

5. Does the district already have AP placements in mind, or are they looking for the vendor to provide a heatmap?

Heatmaps

6. If AP placements are already decided, would it be possible to see the layout for installation quoting purposes?

Not decided. Observations may be made during walk-through on April 19th.

7. Are there any AP placements on high ceilings that would require a lift?

No.

8. Are there any AP placements in gymnasiums?

No.

9. If so, would you like vendors to include protective cages in their quotes?

No.

10. Could you send out floorplans with closets noted?

Attached.

11. Is switching required for this project?

No, but minimal reconfiguration of existing switching may be.

12. If not, what existing switching will be utilized for this project?

HP ProCurve 5400 series with PoE.

13. On page 15 the RFP notes "Where Bid Surety is required" Is bid surety required on this project?

Yes, as stated in the RFP 5% of total.

14. On page 22 the RFP notes the ability to do an on premise appliance or cloud appliance. Does the district have a preference?

No preference.

15. If a vendor is able to offer both, should they quote both?

Yes.

16. Do you have prevailing wage rate I should be using?

Yes, State of RI with certified payrolls.

17. Is a walk-through mandatory and can I schedule with you?

Mandatory walk-through for the wireless will be on Wednesday, April 19th at 11:30 am at Westerly Middle School, 10 Sandy Hill Road, Westerly, RI.

18. Are Floorplans available?

Attached.

Additional information:

6. We will wave this requirement. 1 GBPS is sufficient.

19. Only Basic compatibility. Waved.

21. It will need to support 1000, so controller quoted should reflect scalability, i.e. 7220.

24. We will wave this since E-Rate won't support.

25e. No additional costs or software required, so will wave this.

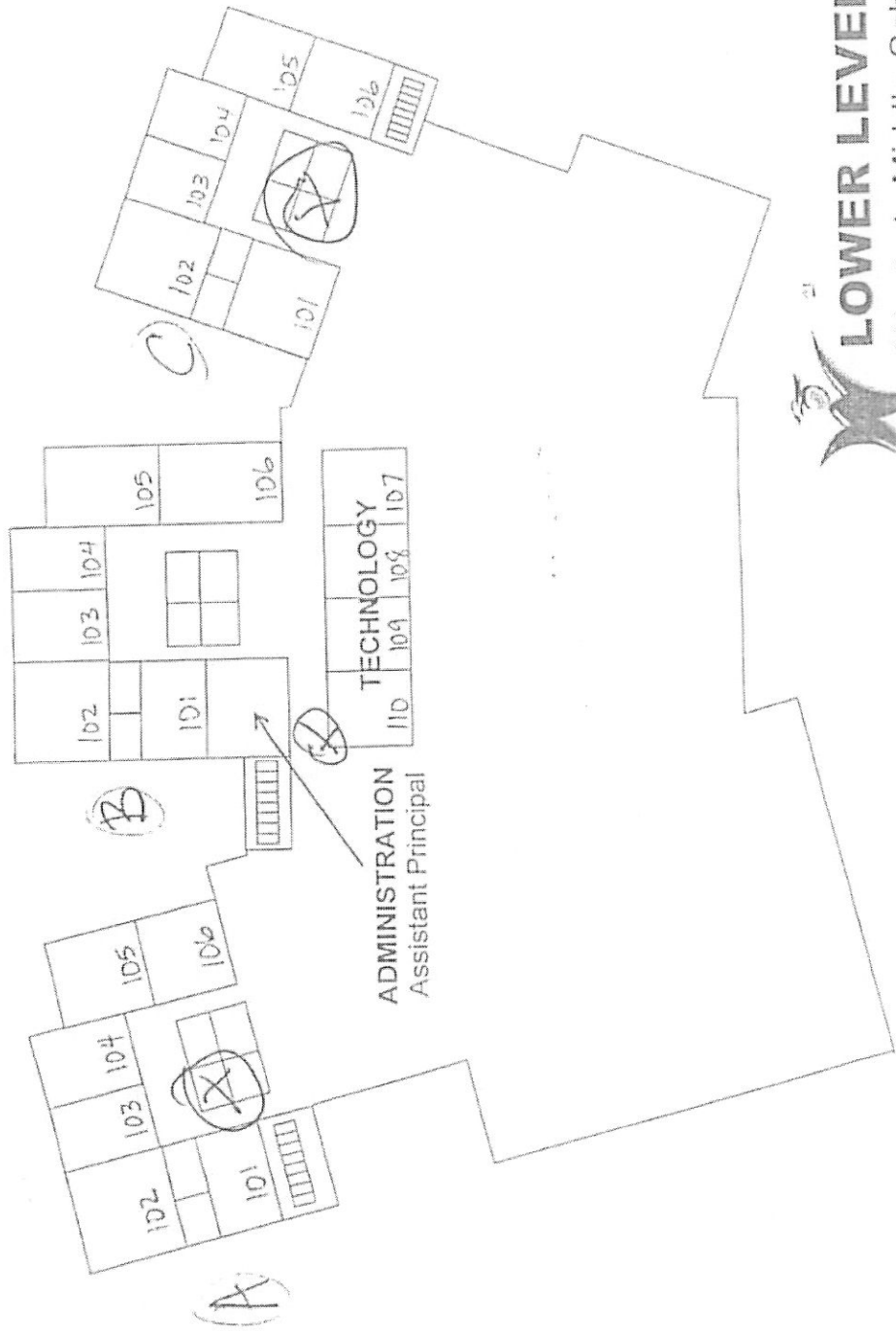

LOWER LEVEL
Westerly Middle School